

**NOTES**

1. Original drawing is by Rowan Pashley 2005, this redrawing by John Evans 2018.
2. The rear walls of the stage are 2.6m high.

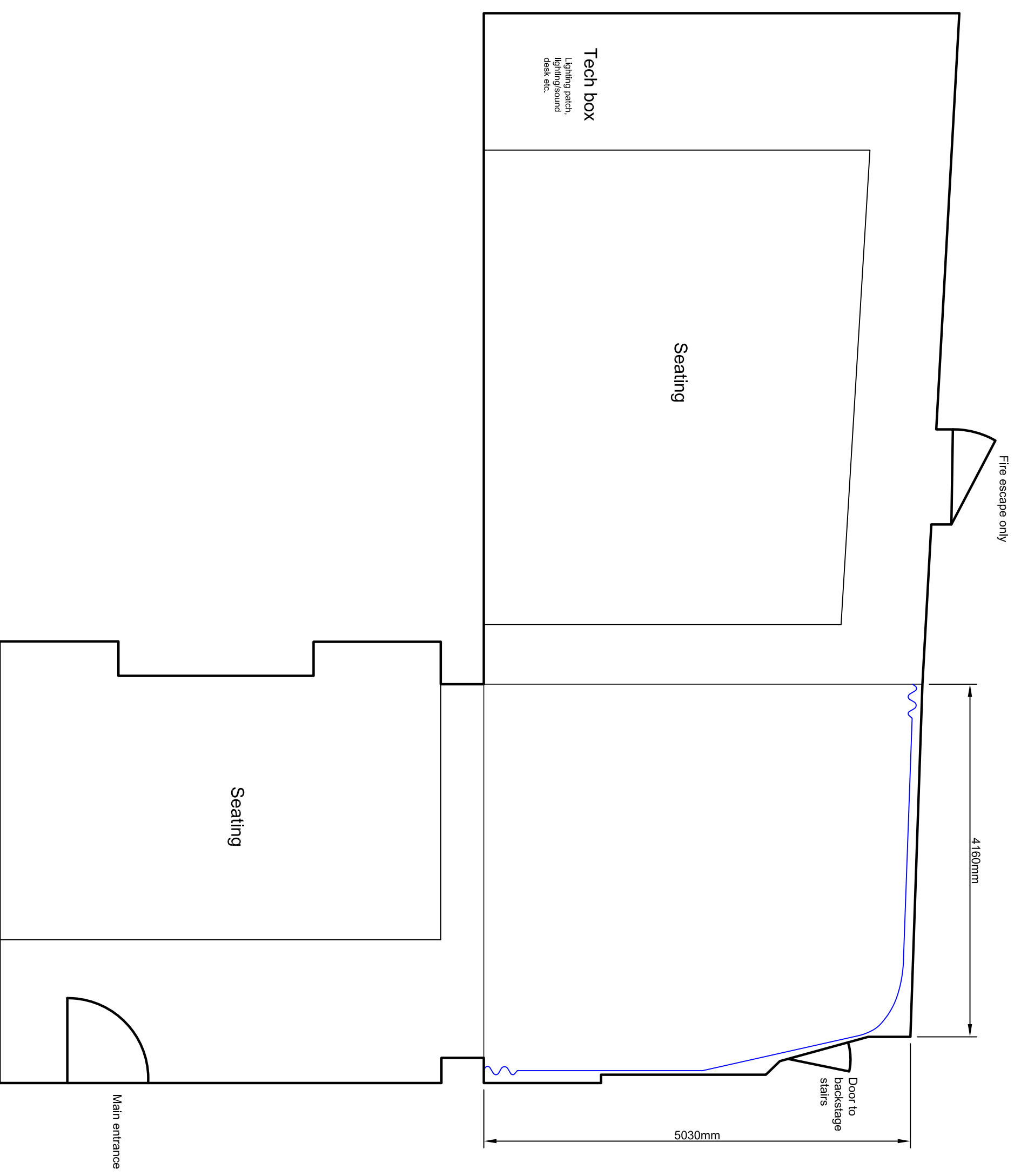

Revision	Description	Date
A	First Issue	17/04/18

Sheet 1 of 1

## General Plan

Revision: **A**

J. Evans

Scale: **1:50 @ A3**

17/04/18